

THE COPYRIGHT OF THIS DRAWING IS VESTED WITH C+W O'BRIEN ARCHITECTS LIMITED AND MUST NOT BE COPIED OR REPRODUCED WITHOUT THE CONSENT OF THE COMPANY.
 FIGURED DIMENSIONS ONLY TO BE TAKEN FROM THIS DRAWING. DO NOT SCALE.
 ALL CONTRACTORS MUST VISIT THE SITE AND BE RESPONSIBLE FOR CHECKING ALL SETTING OUT DIMENSIONS AND NOTIFYING THE ARCHITECT OF ANY DISCREPANCIES PRIOR TO ANY MANUFACTURE OR CONSTRUCTION WORK.

DESIGN INTENT DRAWING
 REFER TO LANDSCAPE AND ENGINEERING DRAWINGS FOR FURTHER INFORMATION



1 Proposed Site Layout Plan - West end
 1:500

- CYCLE PARKING**
- TWO TIER RACK 14 RACKS x 8 BIKES =112 CYCLE PARKING (TYPE A - 8 BIKES)
 - TWO TIER RACK 14 RACKS x 20 BIKES =280 CYCLE PARKING (TYPE B - 20 BIKES)
- TOTAL OF 392 CYCLE PARKING**

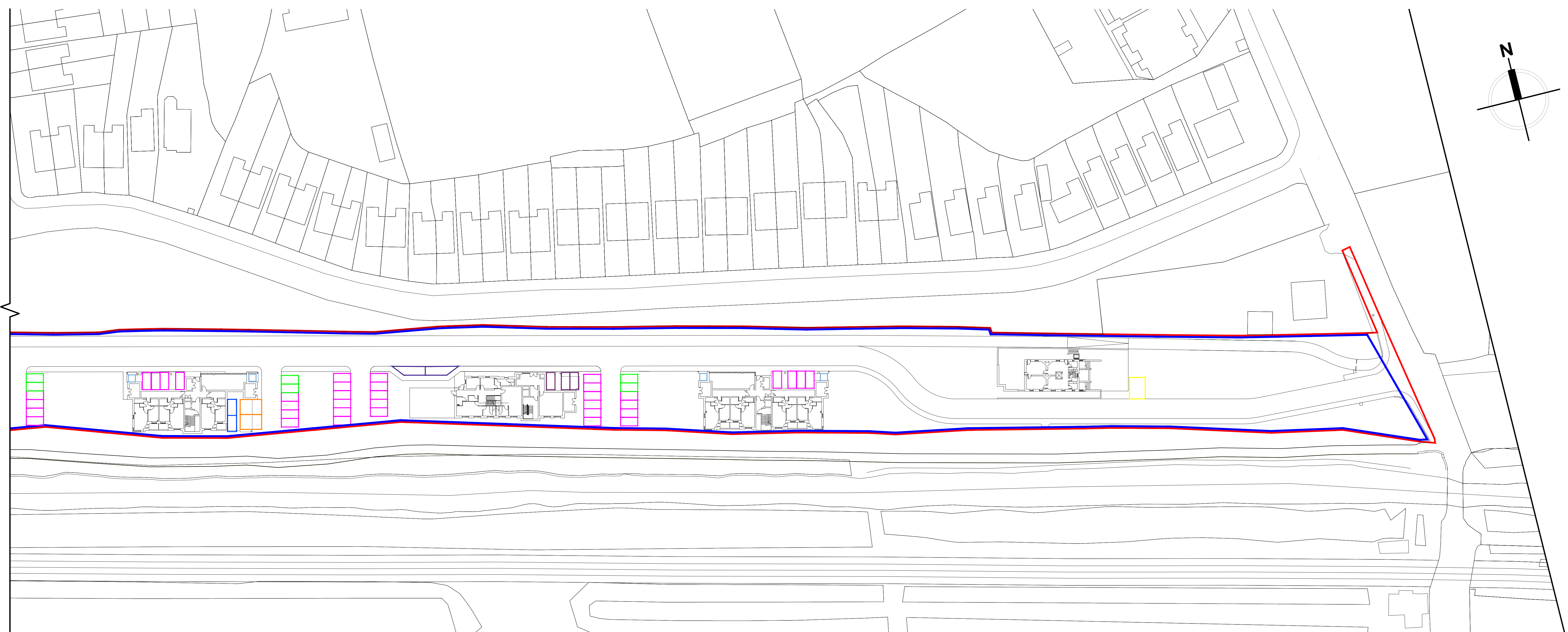

2 Proposed Site Layout Plan - East end
 1:500

- CAR PARKING**
- STANDARD CAR SPACE = 80 PARKING
 - ACCESSIBLE CAR SPACE = 06 PARKING
 - CAR SPACE WITH EV CHARGING = 10 PARKING
 - DESIGNATED SPACES FOR CRECHE STAFF = 03 PARKING
 - SHARED CAR SPACE = 01 PARKING
- TOTAL OF 100 CAR PARKING**
- CRECHE DROP OFF = 02 SPACES

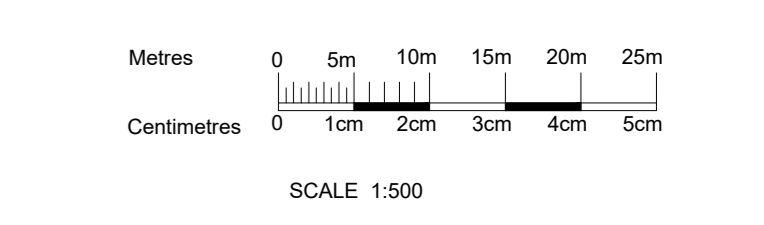

— SITE OUTLINE RED
 — AREA OUTLINE BLUE IS IN THE OWNERSHIP OF APPLICANT

Rev	Description	Date	Dr	App'd by
P01	Planning Submission	Jan 2021	EB	EB

PLANNING

Client: OSH Ventures Limited

Project: Built-to-Rent Residential Development
 Old Schoolhouse Site (former Clonsilla School), Protected Structure RPS No. 700, Porterstown Road, Kellystown, Clonsilla, Dublin 15.

Rev	Drawn	Checked	Paper Size	Scale	Date
GOB	EB	A0	As Indicated	@A0	Jan 2021

Project No: PE18105
 Drawing No: 002008
 Revision: P01

File Name: PE18105-CWO-ZZ-ZZ-DR-A-002008

Status: **A1 - Approved for Planning Stage**