

- NOTES:-
1. DIMENSIONS ONLY TO BE TAKEN FROM THIS DRAWING. DIMENSIONS TO BE CHECKED ON SITE.
 2. THIS DRAWING TO BE READ IN CONJUNCTION WITH ALL OTHER ARCHITECTURAL & ENGINEERING DRAWINGS & ALL OTHER RELEVANT DRAWINGS & SPECIFICATIONS.
 3. ALL LEGS RELATE TO O.S. DRAWING AT MAIN HEAD UNLESS NOTED OTHERWISE.

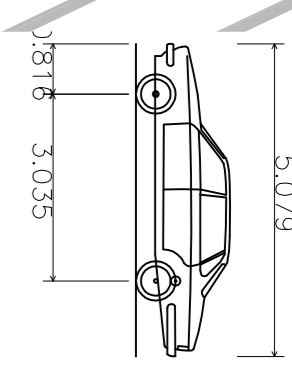

Large Car (2006)
 Overall Length 5.079m
 Overall Width 1.818m
 Overall Body Height 3.035m
 Min Body Ground Clearance 0.310m
 Max Track Width 1.831m
 Lock-to-lock time 4.00s
 Curb to Curb Turning Radius 5.900m

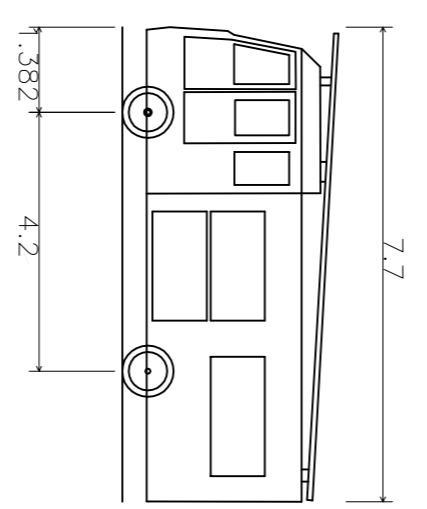

Dennis Sabre Fire Tender (WB)
 Overall Length 7.700m
 Overall Width 2.430m
 Overall Body Height 3.512m
 Min Body Ground Clearance 0.307m
 Track Width 2.350m
 Lock-to-lock time 5.00s
 Curb to Curb Turning Radius 7.400m

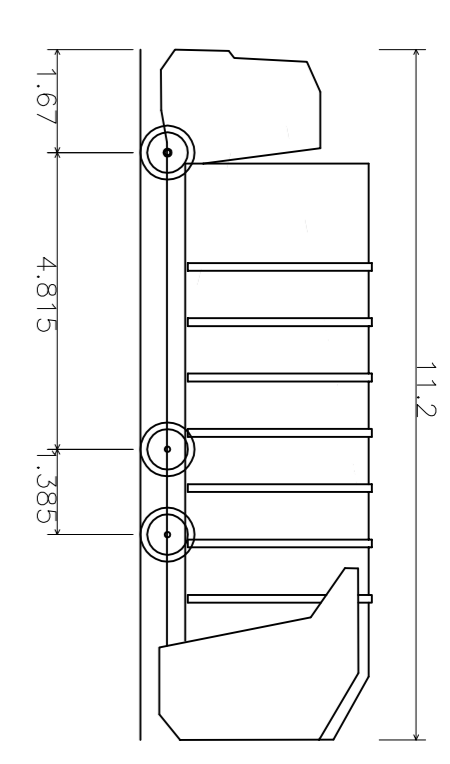
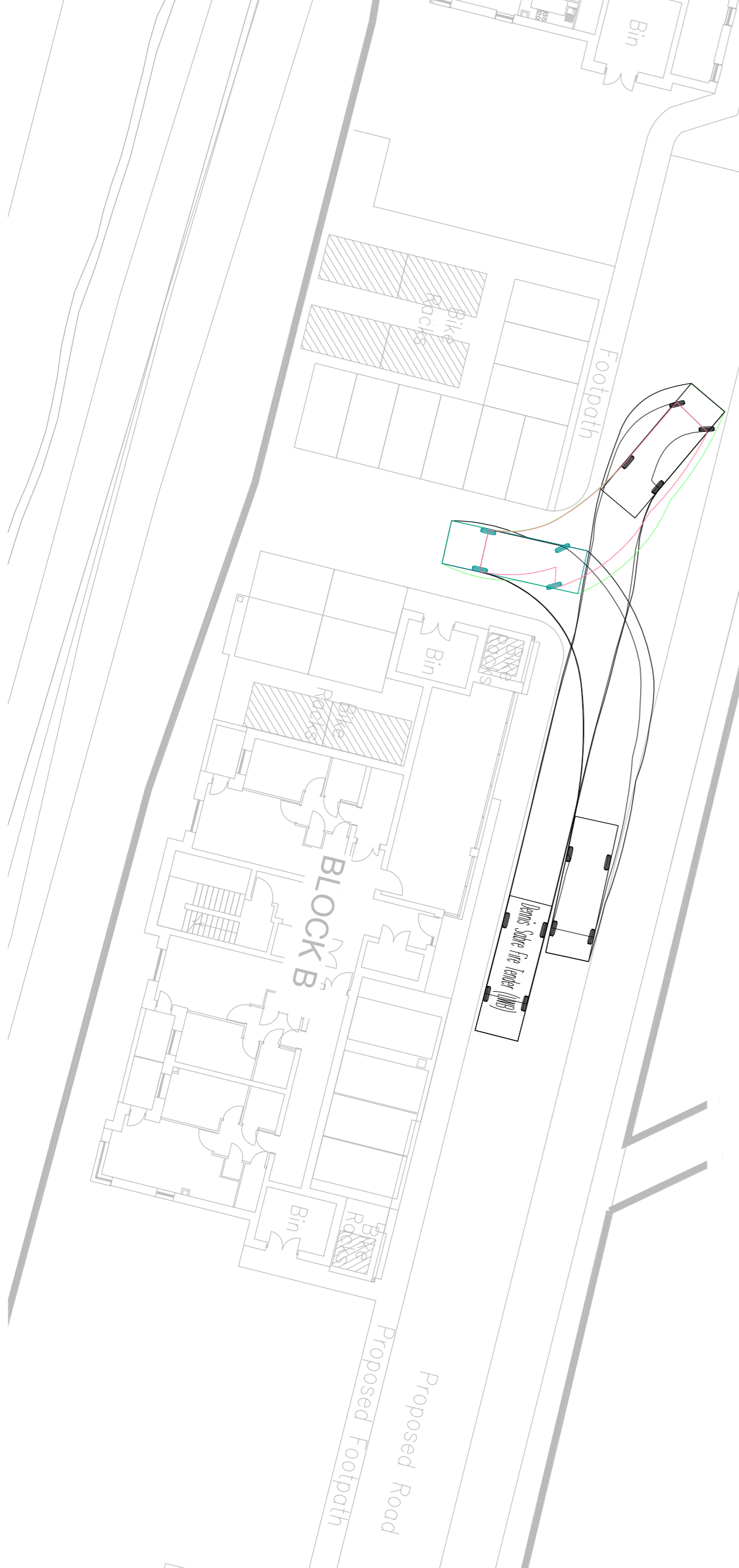

Phoenix 2 Duo (P2-15W with Elite 6x4 chassis)
 Overall Length 11.200m
 Overall Width 2.530m
 Overall Body Height 3.751m
 Min Body Ground Clearance 0.304m
 Track Width 2.500m
 Lock-to-lock time 4.00s
 Curb to Curb Turning Radius 9.500m

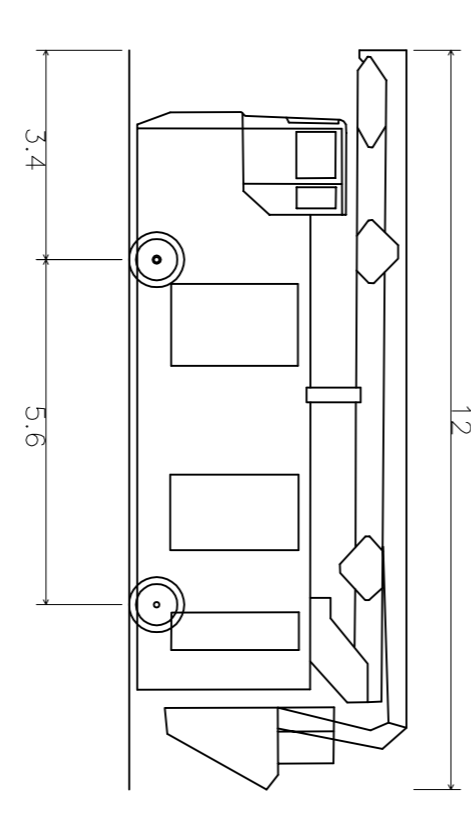

Aerial Platform/ Turntable Ladder/ Special Appliance
 Overall Length 12.000m
 Overall Width 2.550m
 Overall Body Height 4.500m
 Min Body Ground Clearance 0.130m
 Track Width 2.550m
 Lock-to-lock time 4.00s
 Curb to Curb Turning Radius 13.750m



Rev.	Date	Issued by	Checked by	Revision

Status: FOR PLANNING

Architect: CW O'BRIEN LTD

Project: OLD SCHOOLHOUSE SITE (FORMER CLONSILLA SCHOOL, PROTECTED STRUCTURE RPS NO. 700), PORTERSTOWN ROAD, KELLYSTOWN, CLONSILLA, DUBLIN 15

Doc-Title: SWEPT PATH ANALYSIS

THIS DOCUMENT IS THE PROPERTY OF DOHERTY PINEGAN KELLY CONSULTING ENGINEERS. THE DESIGN INFORMATION CONTAINED HEREIN IS STRICTLY CONFIDENTIAL. THIS DOCUMENT IS NOT TO BE USED, REPRODUCED, DISCLOSED OR CIRCULATED IN WHOLE OR IN PART WITHOUT THE PRIOR WRITTEN PERMISSION IN WRITING OF DOHERTY PINEGAN KELLY CONSULTING ENGINEERS. PROPERTY OF DOHERTY PINEGAN KELLY CONSULTING ENGINEERS

DOHERTY PINEGAN KELLY
DOHERTY PINEGAN KELLY
 CONSULTING CIVIL & STRUCTURAL ENGINEERS
 Broome Court, 53 Broome Road,
 Glasnevin, Dublin D09 W2Y5.
 Tel:(01) 8301852 Fax:(01) 8602265
 E-Mail: mailroom@dpk.ie

Drawn By: KeB	Scale: 1:500
Checked By: SG	Date: 07-12-20
Dwg No: 19160/14	Rev: -